

INTERNATIONAL PAPER  
COMPANY 762 ACRES  
RESIDUE OF CALLED  
TRACT 218  
VOL. 156, PG. 03

TRACT 15  
10.080 ACRES

TRACT 4  
10.320 ACRES

TRACT 14  
10.312 ACRES

LEE BROWN STERLING, JR.  
TRUSTEE  
CALLED 201.863 ACRES  
VOL. 1513, PG. 327

LINE TABLE		
LINE	BEARING	LENGTH
L1	N02°21'19"W	225.43'
L2	N01°15'21"W	45.41'
L3	N08°12'23"W	110.66'
L4	N19°31'34"W	106.61'

CURVE TABLE				
CURVE	DELTA	RADIUS	LENGTH	LINE CHORD
C1	55°10'38"	220.00'	211.86'	N26°24'48"W 203.77'

**LEGEND**

FOUND

- IRF 1/2" Iron Rod
- IPF 1/2" Iron Pipe
- CMF Concrete Monument
- Barbed Wire Fence
- Chain Link Fence
- Board Fence
- Overhead Electric Line

SET

- IRS 1/2" Iron Rod
- IPS 1/2" Iron Pipe

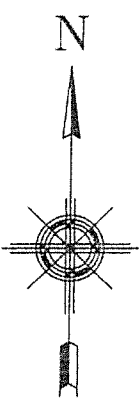

SCALE: 1" = 200'

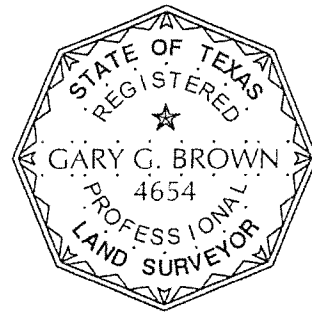

GOODWIN-LASITER, INC.

*Gary G. Brown*  
Gary G. Brown, R.P.L.S. 4654  
Lufkin, Texas July 22, 2006

**G-L** GOODWIN-LASITER, INC.  
ENGINEERS - ARCHITECTS  
SURVEYORS  
1609 S. CHESTNUT ST., SUITE 202 • LUFKIN, TEXAS 75901 • (936) 637-4900 • admin@goodwinlasiter.com  
1509 EMERALD PKWY., SUITE 101 • COLLEGE STATION, TEXAS 77845 • (979) 696-6767 • ctex@goodwinlasiter.com

DATE	DRAWN BY:	APP'D BY:	SCALE	JOB NUMBER
7-22-06	KHL	GGB	1"=200'	255312
BOUNDARY SURVEY TRACT 15 - 10.080 ACRES I.D. THOMAS SURVEY, A-74 POLK COUNTY, TEXAS				SHEET NO.

TRACT 15  
FIELDNOTE DESCRIPTION OF 10.080 ACRES  
I. D. THOMAS SURVEY, ABSTRACT NO. 74  
POLK COUNTY, TEXAS

BEING 10.080 acres, more or less, located in the I. D. Thomas Survey, Abstract No. 74 in Polk County, Texas, being part of the called 201.863 acre tract described in a Deed from Copper Station Holdings, LLC to Lee Brown Sterling, Jr., Trustee dated June 9, 2006 and recorded in Volume 1513, Page 327 of the Official Public Records of Polk County, Texas and being more particularly described as follows:

BEGINNING at a 1/2-inch iron rod set in the northeasterly margin of a graded public road, known locally as Ollie Loop Road, (40 foot wide right of way) for the westerly common corner of the herein described 10.080 acre tract and a 10.012 acre tract created this same day. From said corner, a 1/2-inch iron rod found in the center of the said road for the most northwesterly corner of the said 201.863 acre tract bears N 14° 26' 10" W 990.81 feet;

THENCE N 76° 49' 46" E 903.91 feet with the common line of the said 10.080 acre tract and the said 10.012 acre tract to a 1/2-inch iron rod set for the easterly common corner of the said 10.080 acre tract and the said 10.012 acre tract in the westerly line of a 10.159 acre tract created this same day;

THENCE S 20° 33' 49" E 241.00 feet with the common line of the said 10.080 acre tract and the said 10.159 acre tract to a 1/2-inch iron rod set for the easterly common corner of the said 10.080 acre tract and the said 10.312 acre tract;

THENCE S 51° 37' 15" W 1036.40 feet with the common line of the said 10.080 acre tract and the said 10.312 acre tract to a 1/2-inch iron rod set for the westerly common corner of the said 10.080 acre tract and the said 10.312 acre tract in the northeasterly margin of the said road;

THENCE along the northeasterly margin of the said road and with a curve to the right (having a radius of 220.00 feet, a central angle of 55° 10' 38", and a long chord of N 26° 24' 48" W 203.77 feet) 211.86 feet to a 1/2-inch iron rod set for the end of the said curve;

THENCE N 02° 21' 19" W 225.43 feet continuing along the northeasterly margin of the said road to a 1/2-inch iron rod set for an angle corner;

THENCE N 01° 15' 21" W 45.41 feet continuing along the northeasterly margin of the said road to a 1/2-inch iron rod set for an angle corner;

THENCE N 08° 12' 23" W 110.66 feet continuing along the northeasterly margin of the said road to a 1/2-inch iron rod set for an angle corner;

THENCE N 19° 31' 34" W 106.61 feet continuing along the northeasterly margin of the said road to the PLACE OF BEGINNING, and containing 10.080 acres, more or less, as shown on the accompanying plat of even date herewith.

This survey was made on the ground under my supervision.

GOODWIN-LASITER, INC.

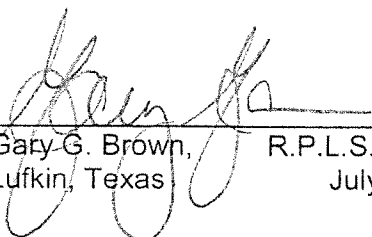
  
\_\_\_\_\_  
Gary G. Brown, R.P.L.S. No. 4654  
Lufkin, Texas July 22, 2006

